

Specification

Nominal Voltage	12V	
Nominal Capacity(20HR)	26.0AH	
Dimension	Length	166±2mm (6.54 inches)
	Width	175±2mm (6.89 inches)
	Container Height	125±2mm (4.92 inches)
	Total Height (with Terminal)	125±2mm (4.92 inches)
Approx Weight	Approx 8.7 kg (19.18lbs)	
Terminal	T12	
Container Material	ABS	
Rated Capacity	26.0 AH/1.3A	(20hr, 1.80V/cell, 25°C/77°F)
	24 AH/2.4A	(10hr, 1.80V/cell, 25°C/77°F)
	19.75 AH/3.95A	(5hr, 1.75V/cell, 25°C/77°F)
	17.28 AH/5.76A	(3hr, 1.75V/cell, 25°C/77°F)
	13.8 AH/13.8A	(1hr, 1.60V/cell, 25°C/77°F)
Max. Discharge Current	240A (5s)	
Internal Resistance	Approx 15.8mΩ	
Operating Temp. Range	Discharge	-20~55°C (-4~131°F)
	Charge	0~40°C (32~104°F)
	Storage	-20~50°C (-4~122°F)
Nominal Operating Temp. Range	25±3°C (77±5°F)	
Cycle Use	Initial Charging Current less than 4.8A. Voltage	
	14.4V~15.0V at 25°C(77°F)Temp. Coefficient -30mV/°C	
Standby Use	No limit on Initial Charging Current Voltage	
	13.5V~13.8V at 25°C(77°F)Temp. Coefficient -20mV/°C	
Capacity affected by Temperature	40°C (104°F)	103%
	25°C (77°F)	100%
	0°C (32°F)	86%
Self Discharge	Leoch LPCG series batteries may be stored for up to 9 months at 25°C(77°F) and then a freshening charge is required. For higher temperatures the time interval will be shorter.	



Typical Applications

- ◆ Railway and marine systems
- ◆ Electric tools
- ◆ Vehicle in place of walking
- ◆ Lawn mowers
- ◆ Golf trolleys and golfcart
- ◆ Electric toys
- ◆ Portable power
- ◆ Wheelchairs
- ◆ Medical equipments.



Constant Current Discharge (Amperes) at 25 °C (77°F)

F.V/Time	10min	15min	20min	30min	45min	1h	2h	3h	4h	5h	6h	8h	10h	20h
1.85V/cell	28.1	23.6	21.2	17.0	13.1	10.9	6.81	5.16	4.25	3.64	3.15	2.51	2.25	1.27
1.80V/cell	33.3	27.6	24.2	19.0	14.4	11.9	7.33	5.52	4.52	3.83	3.30	2.61	2.40	1.30
1.75V/cell	38.3	31.0	27.0	20.6	15.5	12.7	7.70	5.76	4.68	3.95	3.40	2.69	2.47	1.32
1.70V/cell	43.3	34.3	29.2	22.0	16.4	13.3	8.06	5.95	4.81	4.06	3.50	2.75	2.52	1.34
1.67V/cell	46.5	36.3	30.8	23.0	17.0	13.6	8.30	6.13	4.93	4.14	3.56	2.79	2.55	1.35
1.60V/cell	50.7	39.1	32.9	24.4	18.0	13.8	8.57	6.32	5.08	4.25	3.64	2.85	2.59	1.36

Constant Power Discharge (Watts) at 25 °C (77°F)

F.V/Time	10min	15min	20min	30min	45min	1h	2h	3h	4h	5h	6h	8h	10h	20h
1.85V/cell	52.8	44.5	40.2	32.5	25.3	21.2	13.3	10.1	8.34	7.16	6.21	4.97	4.48	2.53
1.80V/cell	61.4	51.3	45.5	36.0	27.6	23.0	14.2	10.7	8.82	7.49	6.48	5.17	4.77	2.58
1.75V/cell	69.8	57.0	50.2	38.7	29.5	24.3	14.9	11.2	9.10	7.72	6.66	5.31	4.92	2.61
1.70V/cell	77.8	62.4	53.8	41.1	30.9	25.4	15.5	11.5	9.33	7.91	6.84	5.42	5.01	2.65
1.67V/cell	82.2	65.1	56.2	42.6	32.0	25.8	15.9	11.8	9.53	8.05	6.94	5.49	5.07	2.69
1.60V/cell	88.1	68.9	59.3	44.7	33.5	26.1	16.3	12.1	9.80	8.24	7.08	5.58	5.15	2.71



Dimensions

T12 Terminal

Unit: mm [inches]

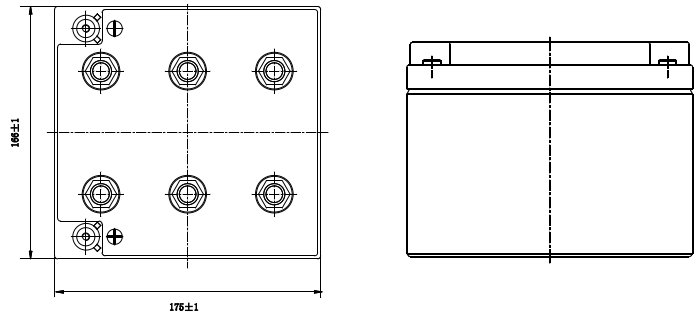
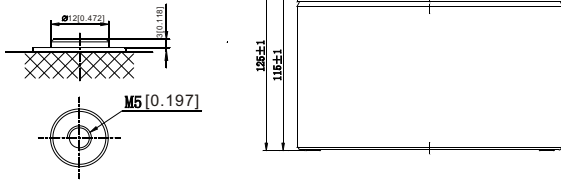

Discharge Characteristics

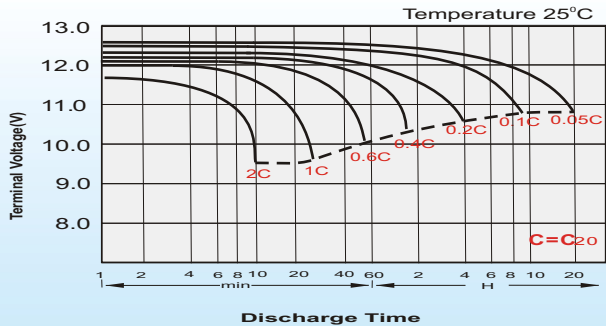

Charging Characteristics (cycle use)

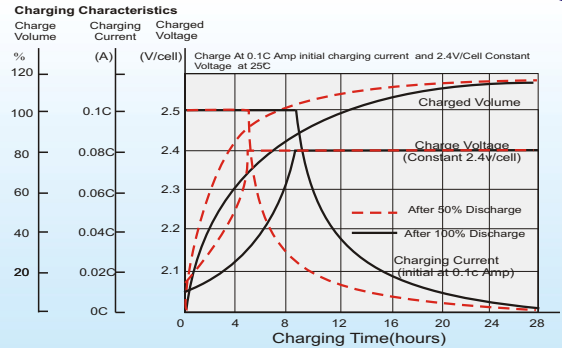

Temperature Effects in Relation to Battery Capacity

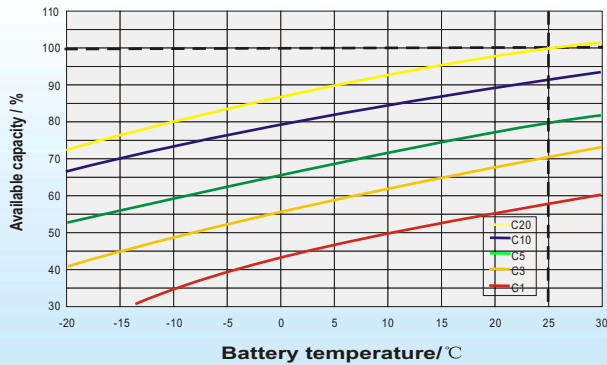

Cycle Life in Relation to Depth of Discharge

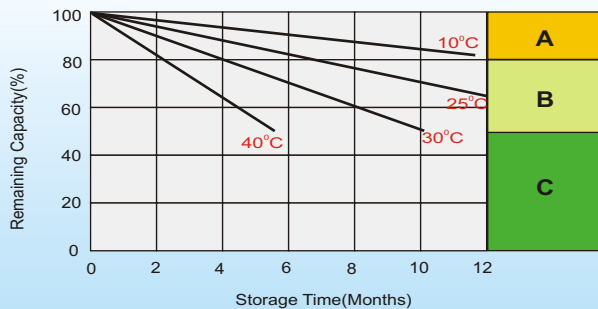
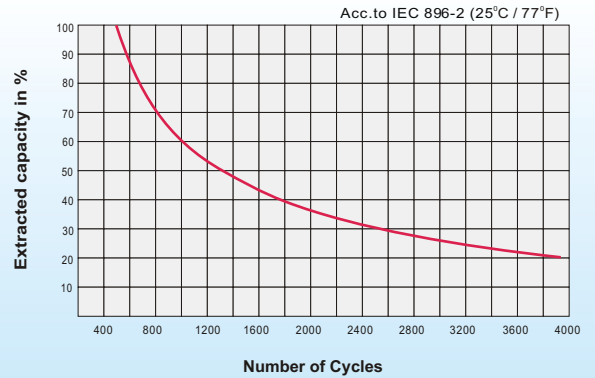

Self Discharge Characteristics

A

No supplementary charge required
(Carry out supplementary charge before use if 100% capacity is required.)

B

Supplementary charge required before use. Optional charging way as below:
1. Charged for above 3 days at limited current 0.25CA and constant volatge 2.25V/cell.
2. Charged for above 20hours at limited current 0.25CA and constant volatge 2.45V/cell.
3. Charged for 8~10hours at limited current 0.05CA .

C

Supplementary charge may often fail to recover the capacity.
The battery should never be left standing till this is reached.

Sales Office

China sales office:

Add: 5th Floor, Xinbaohui Bldg., Nanhai Blvd.,
Nanshan, Shenzhen, China. 518052
Tel: +86-755-86036060 (100 lines)
Fax: +86-755-26067269
E-mail: export@leoch.com
Http://www.leoch.com

HongKong sales office:

Add: Workshop C, 33/F, TML Tower,
No. 3 Hoi Shing Road, Tsuen Wan,
New Territories, Hong Kong
Tel: +852 35786666
Fax: +852 21170016
E-mail: sales.hk@leoch.com

Singapore sales office:

Add: No. 1 Tech Park Crescent,
Singapore 638131
Tel: +65 68416629
Fax: +65 68443210
Email: sales.sg@leoch.com

North America sales office:

Add: 19751 Descartes, Unit A,
Foothill Ranch, CA 92610, USA
Tel: 949-588-5853
Fax: 949-588-5966
E-mail: sales@leoch.us
Http://www.leoch.com

Europe sales office:

Add: 9B Wheatstone Court, Waterwells
Business Park, Gloucester, GL2-2AQ,
UK United Kingdom
Tel: +44(0) 1452 729428 / 1452 729696
Fax: +44 (0)1452-690125
E-mail: Sales.Europe@leoch.com